



## 83 ARGENT COURT

GRAYS, RM17 6TA

£1,400 PCM

AVAILABLE NOW! This rare river front apartment with relaxing south facing views of the River Thames is located within a GATED DEVELOPMENT on 4th floor with LIFT SERVICE and benefiting from a SPACIOUS LOUNGE/KITCHEN, EN-SUIT to the master bedroom with built-in wardrobe and OFFERED FURNISHED WITH WHITE GOODS. Situated within minutes walk to Grays c2c station & town centre making this property ideal for commuters. Plus water rates

**tm**  
thomas marsh

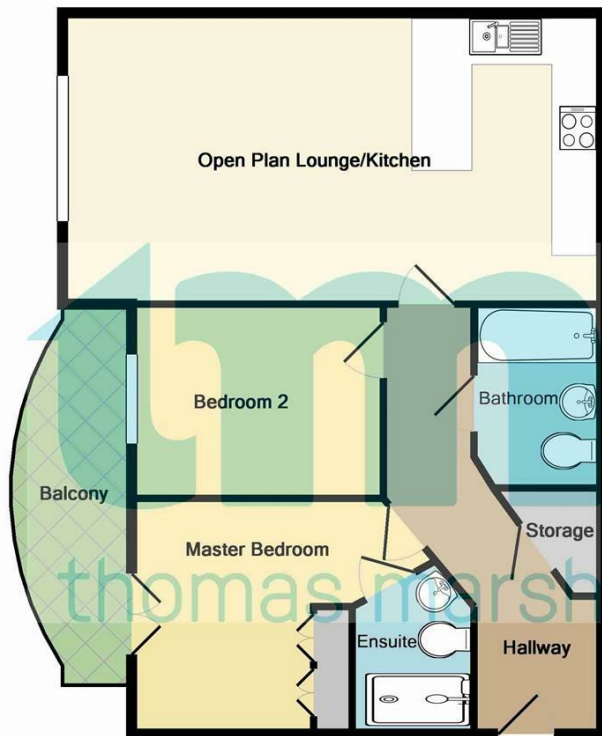

Whilst every attempt has been made to ensure the accuracy of the floor plan contained here, measurements of doors, windows, rooms and any other items are approximate and no responsibility is taken for any error, omission, or mis-statement. This plan is for illustrative purposes only and should be used as such by any prospective purchaser. The services, systems and appliances shown have not been tested and no guarantee as to their operability or efficiency can be given  
Made with Metropix ©2016



Energy Efficiency Rating		
	Current	Potential
Very energy efficient - lower running costs		
(92 plus) A		
(81-91) B	84	86
(69-80) C		
(55-68) D		
(39-54) E		
(21-38) F		
(1-20) G		
Not energy efficient - higher running costs		
England & Wales	EU Directive 2002/91/EC	

Agents Note: Whilst every care has been taken to prepare these particulars, they are for guidance purposes only. All measurements are approximate and are for general guidance purposes only and whilst every care has been taken to ensure their accuracy, they should not be relied upon and potential buyers/tenants are advised to recheck the measurements

Grays Lettings  
47 Orsett Road  
Grays  
Essex  
RM17 5HJ

01375 370779  
lettings@thomas-marsh.com  
www.thomas-marsh.com

